

VYNMSA



BUILDING GROWTH TOGETHER



VYNMSA TORREÓN INDUSTRIAL PARK

Inventory Building &
BTS for Lease

PARK GENERAL INFORMATION

TORREÓN, COAHUILA.

ADVENTAGES:

Airport at less than 30 min drive Highways to:
Airport, Torreón - Saltillo, Laredo TX & Mexico City.

24/7 Controlled access:
Fenced and Gated.

Use: Manufacturing, Assembly & Distribution.

Transportation: Public.

Infrastructure: All On Site.
The Best Available.

Labor Force: Nearby - Easy Access

DISTANCE TO:

Arpto. Intl Francisco Sarabia (TRC)

5 km = 3.10 miles

Laredo, Texas

550 km = 342 miles

Torreón Downtown

8 km = 5 miles

Mexico City

1,015 km = 631 miles

PARK INFRASTRUCTURE:

Water (Park Network)

Sewer (Park Network)

Voice & Data

Energy

CCTV 24/7



GENERAL LAYOUT

VYNMSA TORREÓN INDUSTRIAL PARK

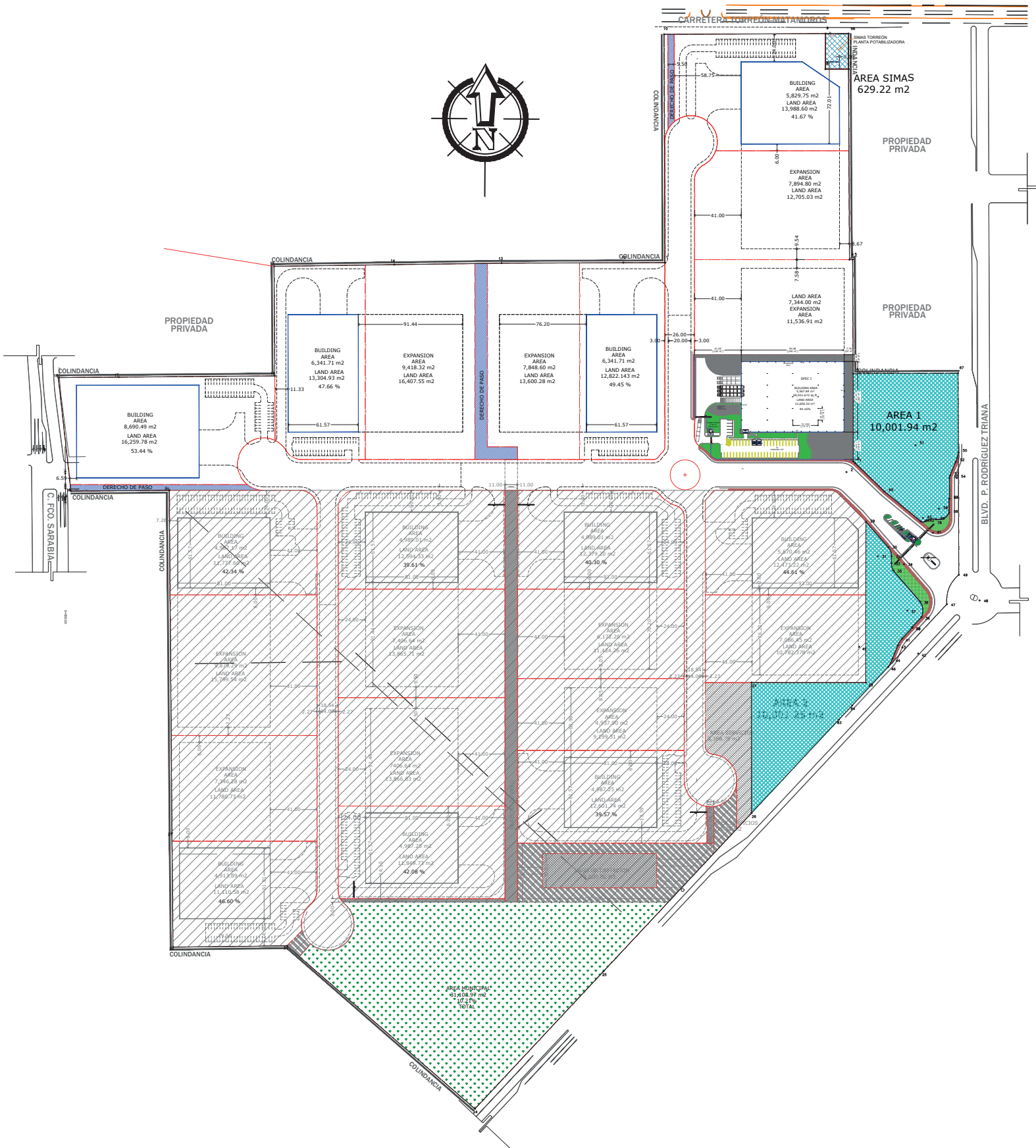

NORTHEAST

VYNMSA PARKS

- ▶ 1. VYNMSA NORTH INDUSTRIAL PARK
- ▶ 2. AIRPORT TECHNOLOGY PARK
- ▶ 3. OMA VYNMSA AERO INDUSTRIAL PARK
- ▶ 4. VYNMSA AEROPUERTO APODACA IND'L PARK
- ▶ 5. VYNMSA APODACA INDUSTRIAL PARK
- ▶ 6. VYNMSA MIGUEL ALEMAN IND'L PARK
- ▶ 7. VYNMSA MONTEMORELOS IND'L PARK
(APPROX. 45 MIN DRIVE FROM MONTERREY TO VMIP)
- ▶ 8. VYNMSA ESCOBEDO PARK
- ▶ 9. VYNMSA ESCOBEDO PARK II
- ▶ 10. VYNMSA SANTA CATARINA IND'L PARK
- ▶ 11. VYNMSA SANTA CATARINA IND'L PARK II
- ▶ 12. VYNMSA METROPOLITAN IND'L PARK
- ▶ 13. VYNMSA RAMOS ARIZPE IND'L PARK
(APPROX. 40 MIN DRIVE FROM MTY TO RAMOS ARIZPE)
- ▶ 14. VYNMSA RAMOS ARIZPE IND'L PARK II
- ▶ 15. VYNMSA RAMOS ARIZPE IND'L PARK III
- ▶ 16. VYNMSA RAMOS ARIZPE IND'L PARK IV
- ▶ 17. VYNMSA TORREÓN INDUSTRIAL PARK
(APPROX. 2.50 HR DRIVE FROM RAMOS ARIZPE TO TORREÓN)

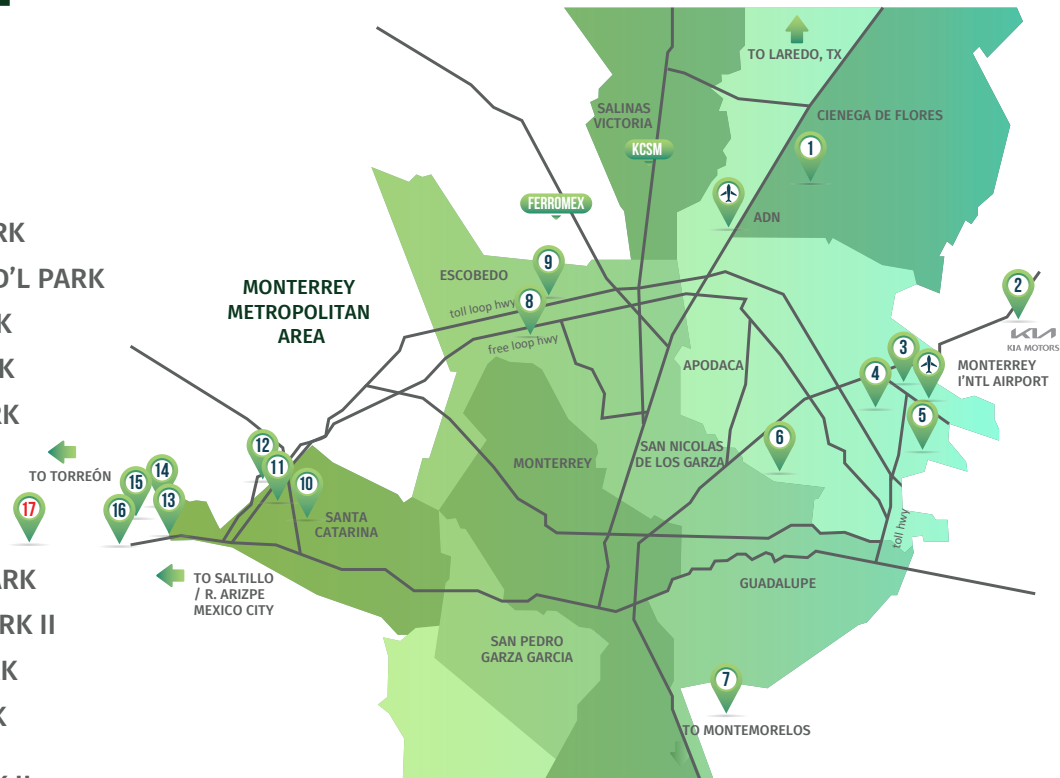

BAJIO AREA

VYNMSA PARKS

- ▶ 1. VYNMSA LEON INDUSTRIAL PARK
- ▶ 2. VYNMSA GUANAJUATO PUERTO INTERIOR I
- ▶ 3. VYNMSA GUANAJUATO PUERTO INTERIOR II
- ▶ 4. VYNMSA GUANAJUATO INDUSTRIAL PARK
- ▶ 5. VYNMSA CELAYA INDUSTRIAL PARK
- ▶ 6. VYNMSA APASEO INDUSTRIAL PARK
- ▶ 7. VYNMSA QUERETARO INDUSTRIAL PARK
- ▶ 8. PARQUE INDUSTRIAL QUERETARO PHASE 4
- ▶ 9. VYNMSA SAN LUIS INDUSTRIAL PARK (LOGISTIK II)



45 AUTOMOTIVE CORRIDOR HWY 57 NAFTA HIGHWAY